

TYPE RP13

Cast Iron EN-GJL-250 PN16

Carbon Steel 1.0619 PN40

Face to face EN 558-1 (DIN 3202)

DESCRIPTION

Series RP13 pressure reducing valve is a self-actuated proportional action type.

Composed by a direct action single seat special body valve, flow tries to close, with diaphragm and feedback spring, controlled by downstream pressure.

The Internal balance without bellow guarantees a long life to the valve.

The series RP13 pressure reducing valve can be simply and easily installed and it is suitable for industrial plants where compressed air is not available for a "pneumatic reducing system" or where the user requires a stable reduced pressure not subjected to frequent variations.

SIZES :

from DN 15 to DN 100

MAX WORKING CONDITIONS :

Maximum inlet pressure with steam, air and gases

DN 15-50	DN 65	DN 80	DN 100
23 bar	16 bar	12 bar	9 bar

Maximum inlet pressure with water

DN 15-50	DN 65	DN 80	DN 100
8 bar	5 bar	4 bar	3 bar

- Maximum design temperature : 220 °C
- Maximum downstream reduced pressure (1) : 8 bar
- Minimum downstream reduced pressure : 0.2 bar

ON REQUEST :

- PTFE/GR Soft seal ≤190°C for class VI°
- PTFE Soft seal ≤150°C for class VI°
- Stellite seat - plug degree 6 (recommended with $\Delta p \geq 12$ bar)
- Reduced bore (see table)

CV = american unit (flowrate in USGPM with 1 psi of differential pressure)

CONNECTIONS :

BODY : flanged UNI 2238 – DIN 2501 PN16 and PN 40
 ACTUATOR : female screwed ISO 7 (BSP) Rp 3/8"

REDUCED PRESSURE RANGES :

TYPE	ACTUATOR	RANGE bar
C1	T.60	3 - 8
C2	T.80	1 - 5
C3	T.100	0.5 - 3
C5	T.150	0.2 - 1.5
(1) C1 special	T50	8 - 12 bar

Where control spring ranges overlap, always use the lower range to give better control and precision

ACCESSORIES :

- KIT for STEAM in carton box (weight 2,2 Kg) composed by pot, cap, fittings and spring adjusting tool
- KIT for WATER and GASES in plastic bag (weight 0,2 Kg) composed by fitting and spring adjusting tool

Kv = metric unit (flowrate in m3/h with 1 bar of differential pressure)

PLUGS PT cl. IV°	NOMINAL DIAMETER								
	DN 15	DN 20	DN 25	DN 32	DN 40	DN 50	DN 65	DN 80	DN 100
Full bore	Ø 1/2"	Ø 3/4"	Ø 1"	Ø 1.1/4"	Ø 1.1/2"	Ø 2"	Ø 2.1/2"	Ø 3"	Ø 4"
CV	2,42	6,12	9,79	17,45	23,89	26,99	43,03	51,38	62,10
KV	2,06	5,22	8,35	14,88	20,38	23,02	36,70	43,82	52,97
Rangeability	6:1	8:1	11:1	14:1	16:1	16:1	16:1	16:1	16:1
Red. bore	Ø 1/4"	Ø 1/2"	Ø 3/4"	Ø 1"	Ø 1.1/4"	Ø 1.1/2"	Ø 2"	Ø 2.1/2"	Ø 3"
CV	1,13	2,42	6,12	9,79	17,45	23,89	26,99	43,03	51,38
KV	0,96	2,06	5,22	8,35	14,88	20,38	23,02	36,70	43,82
Rangeability	5:1	6:1	8:1	11:1	14:1	16:1	16:1	16:1	16:1

NOTE : The downstream pipe diameter must be sized according to the specific volume of steam reduced pressure, to obtain a steam velocity not exceeding 30-35 m/s (maximum limit value = 40 m/s).

CONFLOW s.p.a.

COMPANY
 WITH QUALITY SYSTEM
 CERTIFIED BY DNV
ISO 9001

Via Lecco, 69/71
 20041 AGRATE BRIANZA (MI)
 Tel. 039/651.705 - 650.397
 Fax 039/654.018

COMPONENTS LIST and MATERIALS

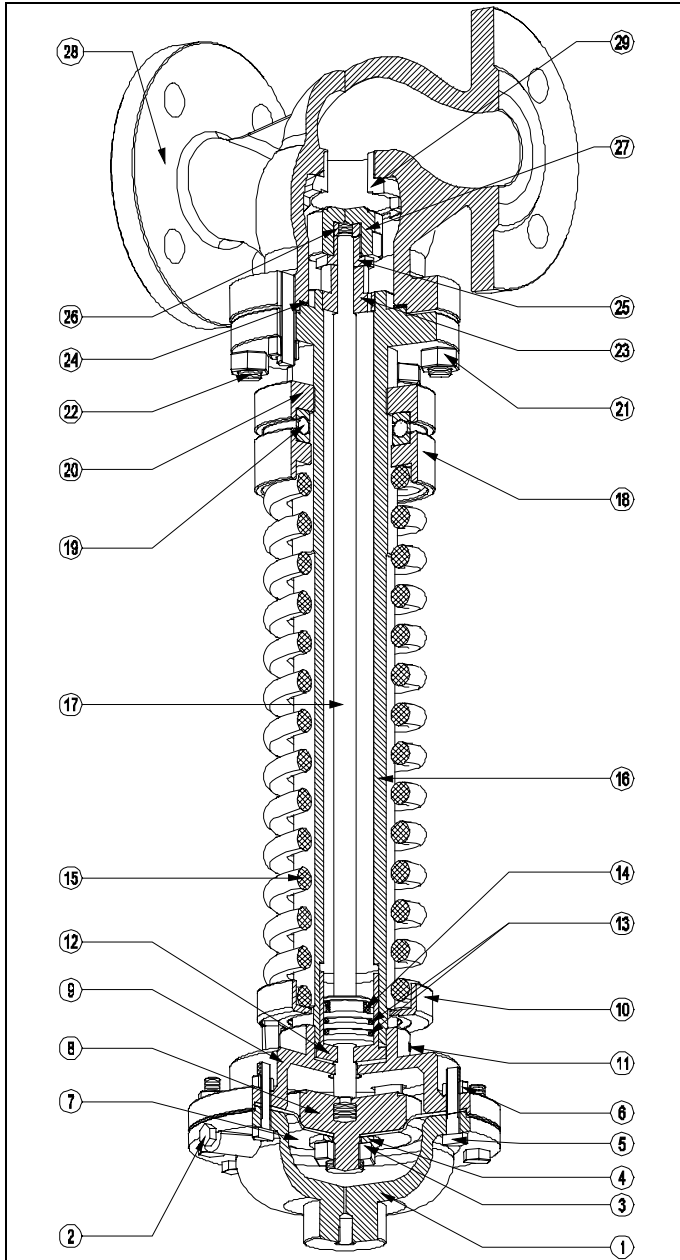

COMPONENTS LIST

1. Upper diaphragm casing
2. Airvent screw
3. Hexagonal locknut
4. Washer
5. Diaphragm casing bolts
6. Diaphragm casing locknuts
7. Diaphragm
8. Diaphragm plate
9. Lower diaphragm casing
10. Lower spring plate
11. Grub screw
12. Airtight guide
13. O-Rings (DN25-DN50)
14. Airtight
15. Spring
16. Yoke
17. Stem
18. Upper spring plate
19. Ball bearing (DN40-100)
20. Spring adjusting plate
21. Body locknuts
22. Stud-bolts
23. Guide bushing
24. Body gasket
25. Plug locknut
26. Entering catch
27. Plug
28. Body
29. Seat
30. Washer (DN15-20)
31. Seeger (DN15-20)

MATERIALS

1. G25 cast iron
2. 4.8 DIN 933 galvanized steel
3. AISI 304 st. steel
4. DIN 125 galvanized steel
5. 8.8 DIN 933 galvanized steel
6. ISO 4033 galvanized steel
7. RubbertexT60-80
NBR T100-150
8. G25 cast iron
9. G25 cast iron
10. UNI 7013-72 bronze
11. 14.9 DIN 914 steel
12. OT58 brass
13. NBR
14. NBR DIN 3760
15. C85 8 steel (DN15-50)
52SiCrNi5 (DN65-100)
16. C40 nickel plated steel
17. AISI 304 st. steel
18. UNI 7013-72 bronze
19. Ref. 51112 steel (DN40-50)
Ref. 51118 steel (DN65-100)
20. UNI 7013-72 bronze
21. ISO 4033 galvanized steel
22. Galvanized steel
23. OT58 brass
24. Centellen WS 3820
PTFE on request
25. AISI 303 st. steel
26. AISI 303 st. steel
27. AISI 304 st. steel
28. G25 cast iron or
GSC-25 (1.0619) carbon steel
29. AISI 304 st. steel
30. OT58 brass
31. DIN 471 steel

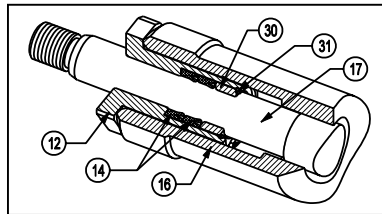

**STEM PACKING
DN 15 - 20**

SPARE PARTS KIT

Diaphragm (part. 7)

- T.60 code T.60.103
- T.80 code T.80.103
- T.100 code T.100.103
- T.150 code T.150.103

Gaskets kit [parts. 12 - 14 (n°2) - 24 - 30 - 31]

- DN 15 code GASKETSRP1315
- DN 20 code GASKETSRP1320

Gaskets kit [parts. 13 (n° 2) - 14 - 24]

- DN 25-32 code GASKETSRP132532
- DN 40-50 code GASKETSRP134050
- DN 65-80 code GASKETSRP136580
- DN 100 code GASKETSRP13100
- (DN 65-80 e DN100 ref. 14 and ref.24 only)

DIMENSIONS (mm) and WEIGHT (Kg)

BODY GROUP

ACTUATOR

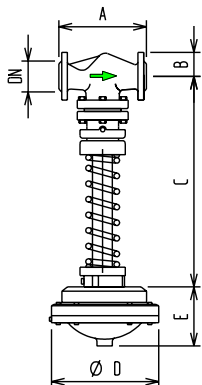

DN	Ø	A	B	C	WEIGHT
15	1/2"	130	47,5	340	5,5
20	3/4"	150	52,5	333	6,5
25	1"	160	57,5	424	10,5
32	1.1/4"	180	70	427	11,5
40	1.1/2"	200	75	476	17,5
50	2"	230	82,5	482	20,0
65	2.1/2"	290	92,5	535	37,0
80	3"	310	100	568	44,0
100	4"	350	PN16 110	PN40 118	578 53,5

ACTUATOR	Ø D	E	WEIGHT
T.60	149	94	3,5
T.80	162	93	5,0
T.100	188	96	6,5
T.150	226	93	10,0

For valve sizing, see leaflet n° 100/VP.

Specifications given are only indicative and not binding for the manufacturer who reserve the right to carry-out any modification deemed necessary without prior notice